

APPENDIX D

Traffic Scheme Consultation



Pinner Road – County Roads Controlled Parking Zone U Proposed Extension

STATUTORY CONSULTATION

IMPORTANT – THIS AFFECTS YOU – PLEASE RESPOND

APPENDIX D

What is this about?

A public consultation was carried out between February 2011 and July 2011, asking residents and businesses along county roads whether they would like a CPZ in their road.

The results of this public consultation were presented to the Traffic and Road Safety Advisory Panel (TARSAP) on 20th September 2011. TARSAP were asked to approve the recommendations made in the report to take the changes forward to Statutory Consultation. The recommendations were based on the responses from the residents and businesses during the consultation.

The report was presented to the Portfolio Holder for Environment and Community Safety for his final approval. The recommendations and TARSAP report can be viewed on Harrow Council website at - <http://tinyurl.com/cnns8fk>

The link will need to be entered into your web browser. If you do not have personal access to the internet the council public libraries do have internet access that residents may use. Alternatively hard copies can be provided on request. The recommendations are also summarised below for your convenience.

The Portfolio Holder agreed the recommendations to take the scheme to the next stage, which is Statutory Consultation. Statutory Consultation is the legal process that the council is required to undertake before any changes can be made to any waiting or loading restrictions, or designated parking bays on the public highway.

Summary of recommendations, which can be viewed in association with the enclosed plans, are as below.

Proposals for County Roads:

- 1) **Extension to the Pinner Road Controlled Parking Zone (CPZ)** permit parking for residents with the operational hours of 11am – 12 noon Monday to Friday is proposed in the following roads and or sections of roads:
 - a) Bedford Road
 - b) Rutland Road
 - c) Oxford Road
 - d) Dorset Road and
 - e) Eastern side of Devonshire Road fronting nos. 44 to 74, inclusive

- 2) **Double yellow line waiting restrictions** – We are taking the opportunity to introduce or extend short sections of existing double yellow lines at all junctions, bends and narrow roads within the area of proposed extension of CPZ. These are designed to improve visibility for drivers, deter obstructive parking that could affect emergency services throughout the area of proposed extension of CPZ. Double yellow lines are also proposed along county roads to facilitate passing space for vehicles.

APPENDIX D

Proposals for Neptune Road:

It is proposed to regulate Neptune Road with a variety of parking controls designed to accommodate most users. A combination of loading bays, free parking places, pay and display and shared use permit/pay and display parking is proposed. Please refer to enclosed plan for more details.

What happens next?

As mentioned earlier this is the Statutory Consultation stage, which is the legal requirement that the council needs to complete. The plans have been developed taking into account, where practical, all the comments we received during the previous consultation stages.

This is your opportunity to review the plans in private and make any further comments. It will not be possible to add any further amendments now, as the scheme has been developed using previous resident and business comments. However, small changes that do not impact on the safety for the wider community may still be possible or the changes could be abandoned.

We shall advertise the Traffic Management Order by placing notices on street lamp columns and in a local paper on or about 19th July 2012 which will also explain where the plans can be seen, this would give anyone a chance to comment or place a formal objection if they wish to do so by **8th August 2012**.

The results and any formal objections will be presented to TARSAP for consideration to proceed to implementation on the agreed measures. It is anticipated that the results will be reported to TARSAP on 29th November 2012. If there are any formal objections then TARSAP will determine what action needs to be taken for the elements of the scheme to be progressed. Once approval to proceed has been obtained the scheme will be given to our contractors to implement and all residents will be informed of the outcome.

Parking permit charges

The current annual resident parking charges in Harrow are:

1st Vehicle in household	£60
2nd Vehicle	£90
3rd Vehicle	£120
4th and subsequent Vehicle	£150

Environmentally friendly vehicles are not subject to charging, but a permit still needs to be displayed. Motorcycles do not need a permit and can also park free-of-charge in any pay and display bay or permit bay in Harrow.

Visitor permits are £15 per book of 10, which is reduced to £7.50 for senior citizens or those receiving mobility benefits if the discount is claimed.

There is no charge for environmentally friendly vehicles, but a permit is still required.

APPENDIX D

Making a formal statutory objection

Under the legislation which controls the statutory consultation process anyone, local resident/business or not, can make a formal objection to the proposals. However the objection needs to be made in **writing (email is acceptable)** including the word **object** or **objection** (to distinguish it clearly from comments) and the **reason** for the basis of the objection with your name and address. The law sets out strict timetable for considering formal objections.

We have provided a questionnaire with space for your comments. Please return the questionnaire using the pre-paid envelope provide or alternatively complete the on-line form available at www.harrow.gov.uk/trafficconsultations Objections to the scheme proposals can also sent to:

Traffic and Highway Network Management
Harrow Council
PO Box 39
Civic Centre
Harrow
HA1 2XA

Or by email to transportation@harrow.gov.uk

Quoting Ref: DP 2012-10 ensuring it is received by 8th August 2012.

More information

If you have any further questions, or wish to comment, please contact the project engineer:

Tushar Patel
Tel: 020 8424 7534
Email: transportation@harrow.gov.uk

or write to:
Tushar Patel
Parking and Sustainable Transport
Harrow Council
P.O. Box 39
Civic Centre,
Harrow
HA1 2XA

APPENDIX D

PINNER ROAD – COUNTY ROADS CONTROLLED PARKING ZONE PROPOSED EXTENSION - QUESTIONNAIRE

Please complete this questionnaire.

Please return your comments by **8th August 2012**. In an effort for the council to be more energy and cost effective, you can submit your questionnaire on-line by visiting www.harrow.gov.uk/trafficconsultations and then clicking to visit live consultations. This will direct you to a page containing the **Pinner Road – County Roads CPZ Extension -Phase 2.** You may be asked to register your details before completing the survey.

Alternatively you may still complete this hard copy and return it using the enclosed prepaid reply envelope (no stamp required), to arrive by **8th August 2012**.

Questionnaires returned without a name and address will not be officially recorded in the results. We count your household / business as one response.

REMEMBER – Responses will not be counted as a statutory objection unless the word “object” or “objection” is mentioned along with the reason for the basis of the objection with your name and address.

Due to the large number of responses anticipated, we cannot reply to you individually.

First Name Family Name

Business Name (if applicable)

Property Number/Name Street Name

Postcode Date

Please tick the most appropriate answer to each of the questions below, and use the space for comments on the back of this sheet if you need to.

If you are not sure about any of the questions, please contact the project engineer whose details are given in the accompanying leaflet and at the above website address.

Q1 Are you a resident or business?

Resident

Business

Both

Q2 Do you support the revised parking proposals in your part of the road?

Yes

No

No opinion

Please use the space on the back of this sheet to clarify your response.

If you have any comments, please use the space provided on the back of this sheet.

If you do NOT want your response to be available for public inspection please tick here.



APPENDIX D

Please call the number below for a large print version of this document, or a summary of this document in your language.

- Albanian** Nëqoftëse gjuha Angleze nuk është gjuha juaj e parë, dhe keni nevojë për përkthimin e informatave të përmbajtura në këtë dokumentë, ju lutemi kontaktoni numërin dhënë.
- Arabic** اذا كانت الانجليزية ليست لغتك الاولى وتحتاج لترجمة معلومات هذه الوثيقة، الرجاء الاتصال على رقم
- Bengali** যদি ইংরেজি আপনার মাতৃভাষা না হয় এবং আপনি যদি এই প্রচারণার তথ্যগুলোর অনুবাদ পেতে চান তাহলে যে টেলিফোন নম্বর দেওয়া আছে সেখানে নয়। কল করে যোগাযোগ করুন।
- Chinese** 如果你主要說用的語言不是英語而需要將這份文件的內容翻譯成中文，請打註明的電話號碼提出這個要求。
- Farsi** اگر انگلیسی زبان اول شما نیست و شما نیاز به ترجمه اطلاعات موجود در این مدرک را دارید، لطفاً با شماره داده شده تماس بگیرید.
- Gujarati** જો ઈંગ્લિશ તમારી પ્રથમ ભાષા ન હોય અને આ દસ્તાવેજમાં રહેલ માહિતીનો તરજૂમો (ટ્રાન્સલેશન) તમને જોઈતો હોય તો કૃપા કરી જણાવેલ નંબર ઉપર ફોન કરો.
- Hindi** यदि आपको अंग्रेजी समझ नहीं आती और आपको इस दस्तावेज़ में दी गई जानकारी का अनुवाद हिन्दी में चाहिए तो कृपया दिए गए नंबर पर फोन करें।
- Panjabi** ਜੇ ਤੁਹਾਨੂੰ ਅੰਗਰੇਜ਼ੀ ਸਮਝ ਨਹੀਂ ਆਉਂਦੀ ਤੇ ਤੁਹਾਨੂੰ ਇਸ ਦਸਤਾਵੇਜ਼ ਵਿਚ ਦਿੱਤੀ ਗਈ ਜਾਣਕਾਰੀ ਦਾ ਤਰਜਮਾ ਪੰਜਾਬੀ ਵਿਚ ਚਾਹੀਦਾ ਹੈ ਤਾਂ ਕਿਰਪਾ ਕਰਕੇ ਦਿੱਤੇ ਗਏ ਨੰਬਰ ਤੇ ਫੋਨ ਕਰੋ।
- Somali** Haddii Ingiriisku uusan ahayn afkaaga koowaad aadna u baahan tahay turjumidda xog ku jirta dokumentigan fadlan la xiriir lambarka lagu siiyey.
- Tamil** ஆங்கிலம் உங்கள் தாய்மொழியாக இல்லாதிருந்து இப்பத்திரத்திலிருக்கும் தகவலின் மொழிபெயர்ப்பு உங்களுக்கு தேவையப்பட்டால் தயவுசெய்து தரப்பட்ட தொலைபேசி எண்ணில் தொடர்பு கொள்ளவும்.
- Urdu** اگر انگریزی آپ کی مادری زبان نہیں ہے اور آپ کو اس دستاویز میں دی گئی معلومات کا اردو ترجمہ درکار ہے، تو براہ کرم دیئے گئے نمبر پر رابطہ کریں۔

020 8424 7534

APPENDIX D

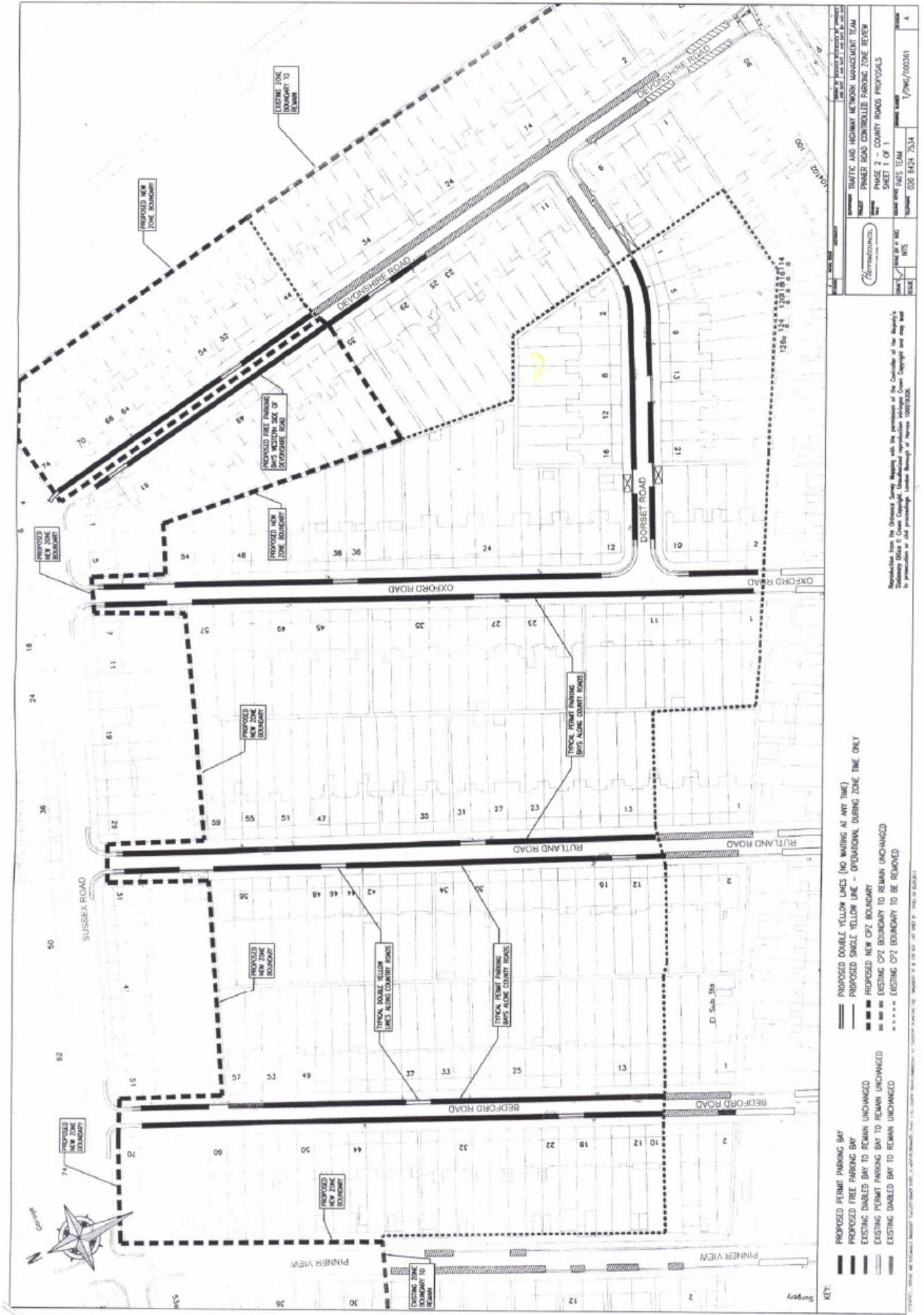

- KEY:**
- PROPOSED PERMIT PARKING BAY
 - PROPOSED FREE PARKING BAY
 - EXISTING DISABLED BAY TO REMAIN UNCHANGED
 - EXISTING PERMIT PARKING BAY TO REMAIN UNCHANGED
 - EXISTING DISABLED BAY TO REMAIN UNCHANGED
 - EXISTING PERMIT PARKING BAY TO BE REMOVED
 - EXISTING DISABLED BAY TO BE REMOVED
 - PROPOSED DOUBLE YELLOW LINES (NO WAITING AT ANY TIME)
 - PROPOSED SINGLE YELLOW LINE - OPERATIONAL DURING ZONE TIME ONLY
 - PROPOSED NEW CPZ BOUNDARY
 - EXISTING CPZ BOUNDARY TO REMAIN UNCHANGED
 - EXISTING CPZ BOUNDARY TO BE REMOVED

APPENDIX D

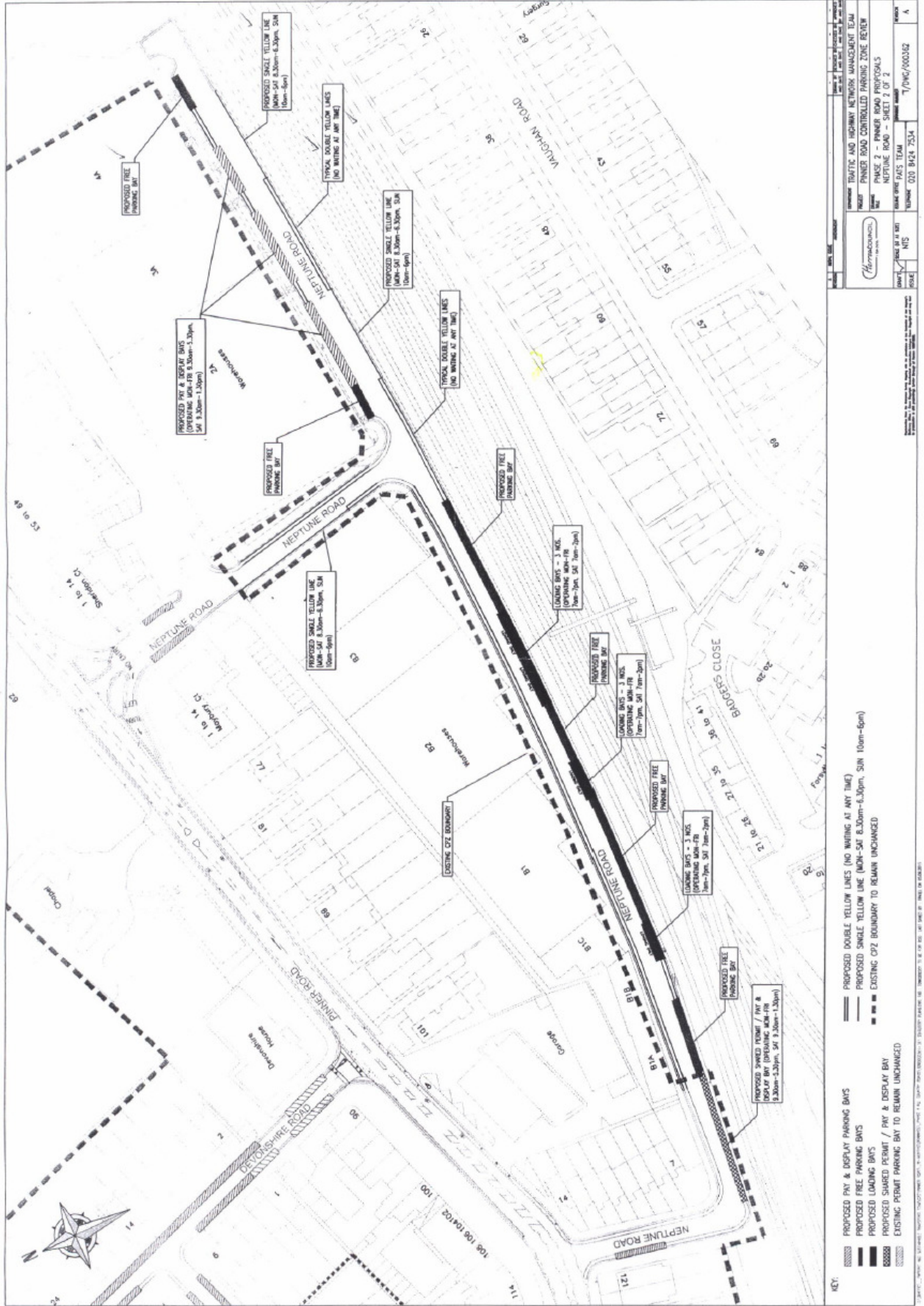

Project Name	TRAFFIC AND HIGHWAY NETWORK MANAGEMENT TEAM
Client	TRAFFIC AND HIGHWAY NETWORK MANAGEMENT TEAM
Phase	PHASE 2 - PINNER ROAD PROPOSALS
Sheet	NEPTUNE ROAD - SHEET 2 OF 2
Scale	AS SHOWN
Date	1/16/2012
Drawn by	W. JONES
Checked by	W. JONES
Project No.	020 BR24_25/4
Revision	1/16/2012/000342
Author	A

KEY:

- PROPOSED PKWY & DISPLAY PARKING BAYS
- PROPOSED FREE PARKING BAYS
- PROPOSED LOADING BAYS
- PROPOSED SHARED PERMIT / PKWY & DISPLAY BAY
- EXISTING PERMIT PARKING BAY TO REMAIN UNCHANGED
- PROPOSED DOUBLE YELLOW LINES (NO WAITING AT ANY TIME)
- PROPOSED SINGLE YELLOW LINE (MON-SAT 8:30am-6:30pm, SUN 10am-6pm)
- EXISTING CPZ BOUNDARY TO REMAIN UNCHANGED